

Fiche Produit



Bardage aluminium

Un système de bardage aluminium architectural offrant une grande variété de conceptions en termes de typologies, d'applications, de couleurs et de textures.



Profilés de bardage aluminium proposant des solutions légères et design pour couvrir de grandes surfaces, appliqués aussi bien à l'extérieur qu'à l'intérieur des bâtiments, en améliorant l'esthétique générale et en augmentant les niveaux d'énergie.



DHK CHATELINAU
Rue de Wallonie 3
6200 Châtelineau
071/24.40.42
info@dhk.be

DHK LUXEMBOURG
Rue d'Arlon, 22
L-8399 Windhof
027/39.55.62
info@dhk.lu

WD-2020 / 20x20 mm

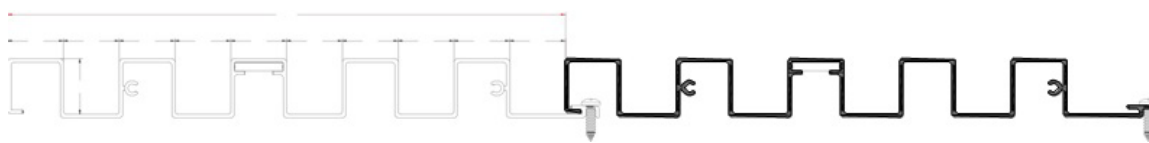

Epaisseur des profilés 1,2mm

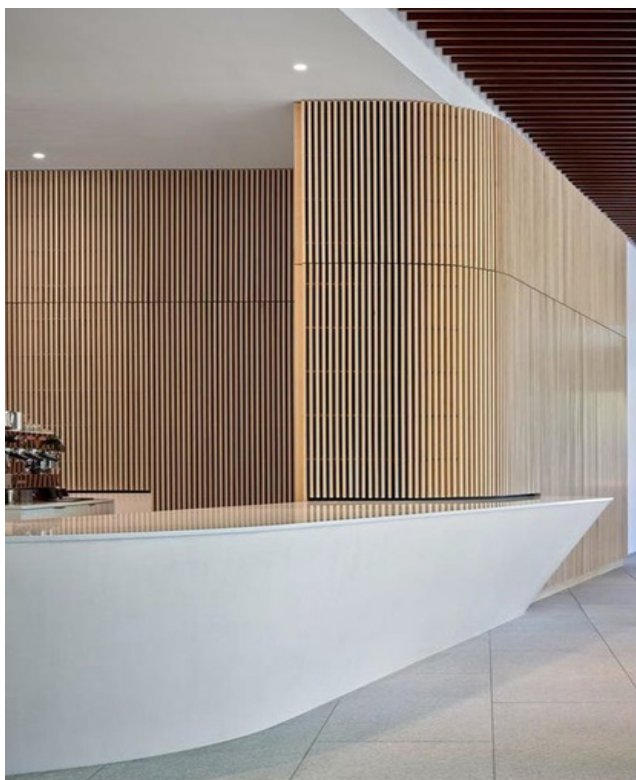
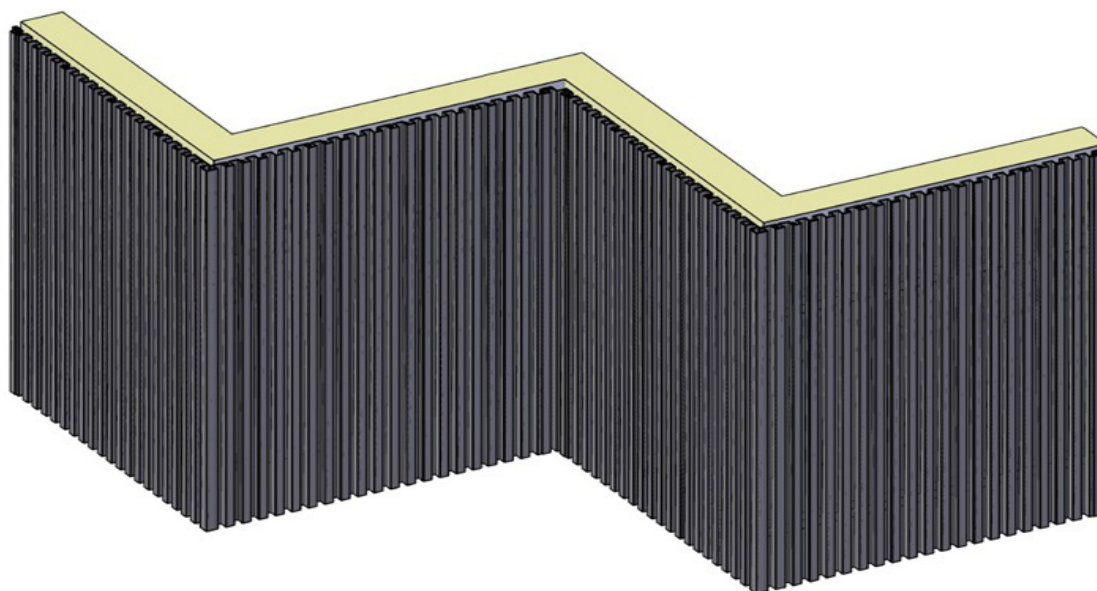

WD-2030 / 30x20 mm

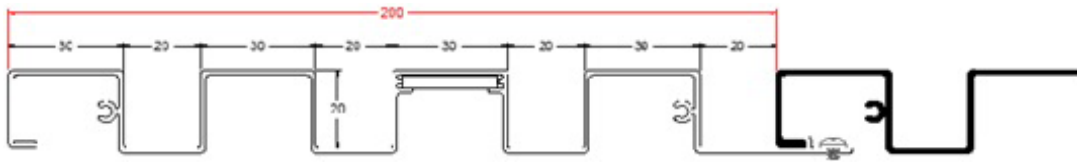

Epaisseur des profilés 1,2mm

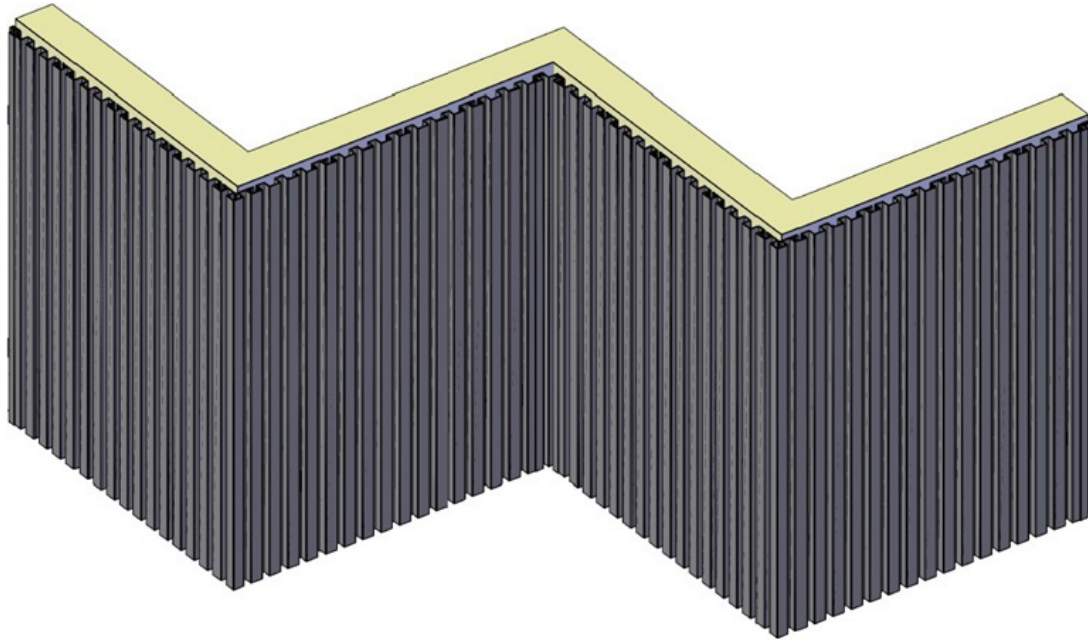

WD-2030 / 30x20 mm - LED SYSTEM

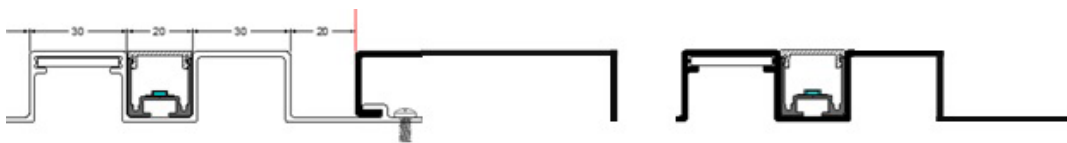

Epaisseur des profilés 1,6mm

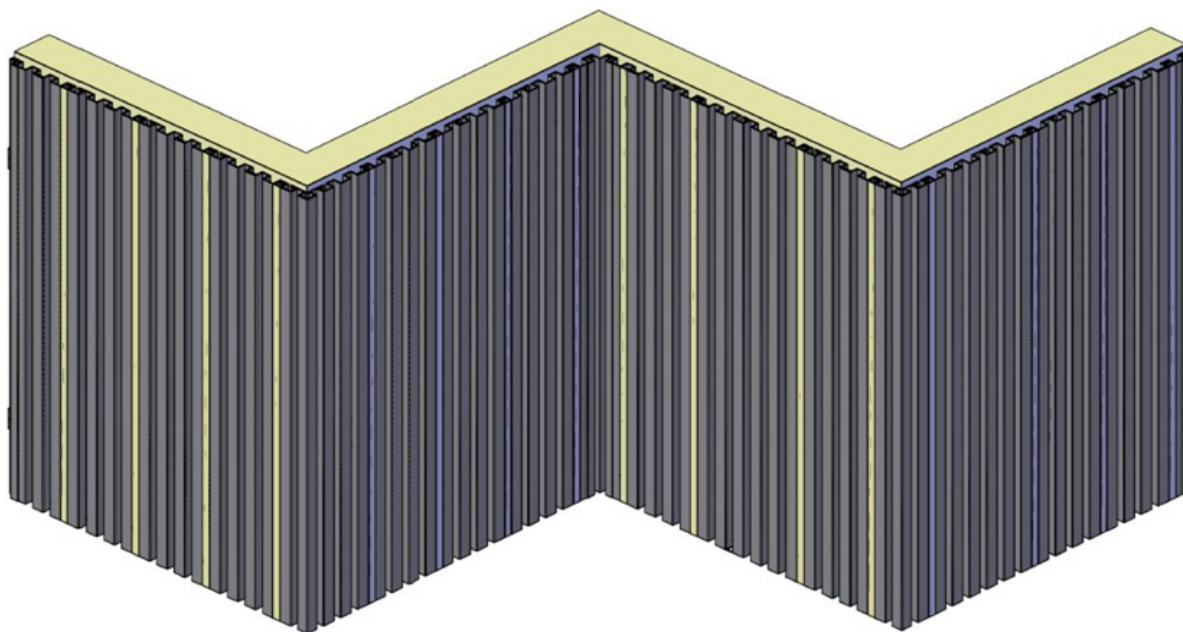

WD-2040 / 40x20 mm

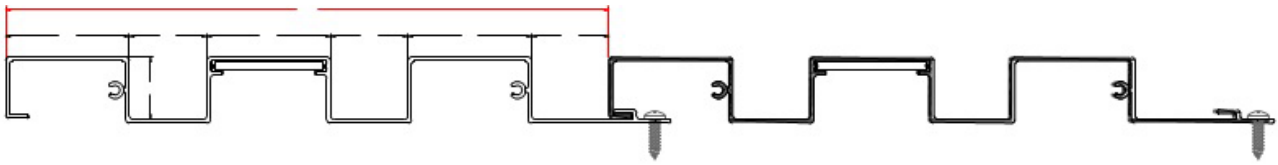

Epaisseur des profilés 1,2mm

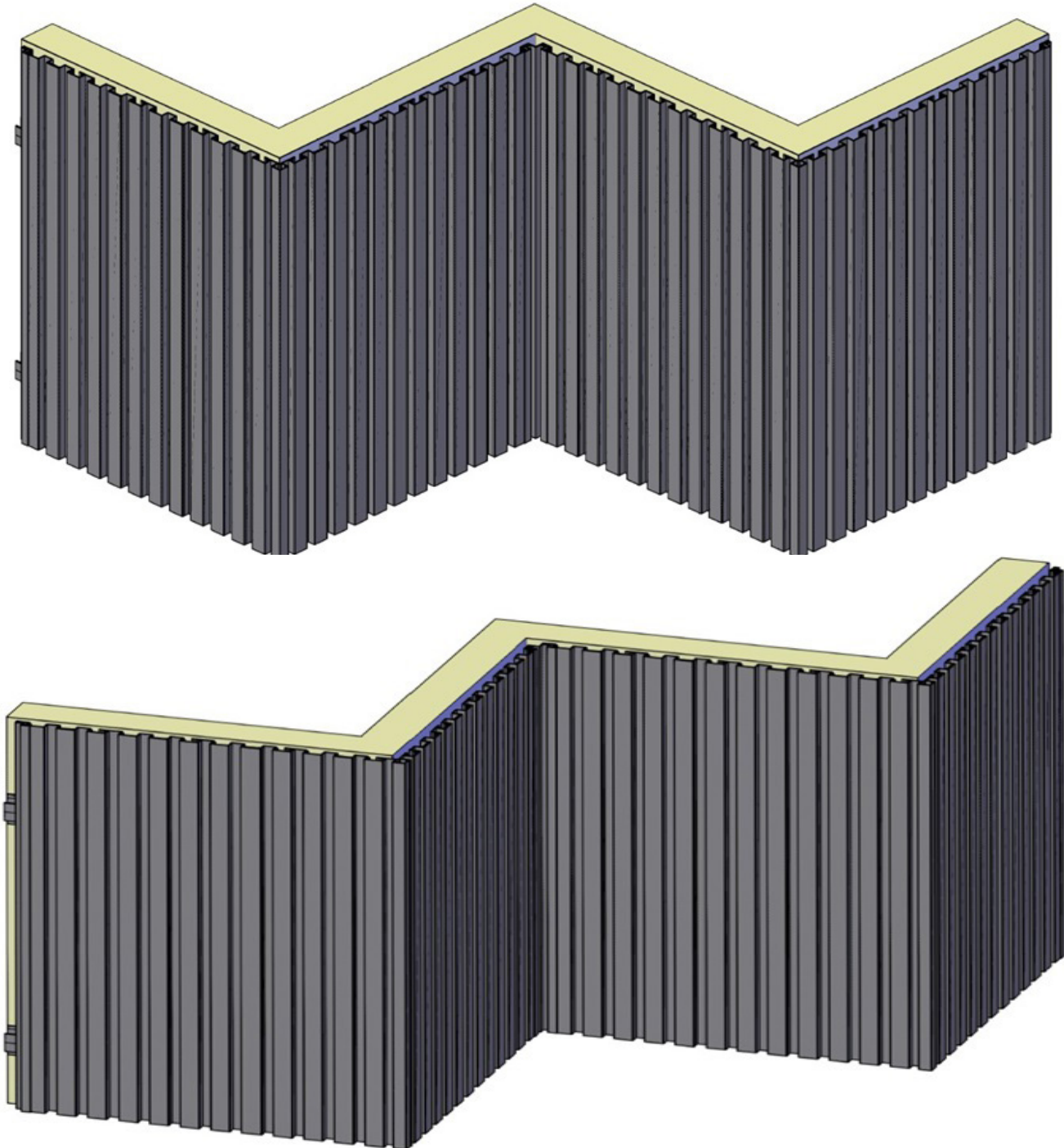



WD-2050 / 40x20 / 40x50/30x30 mm

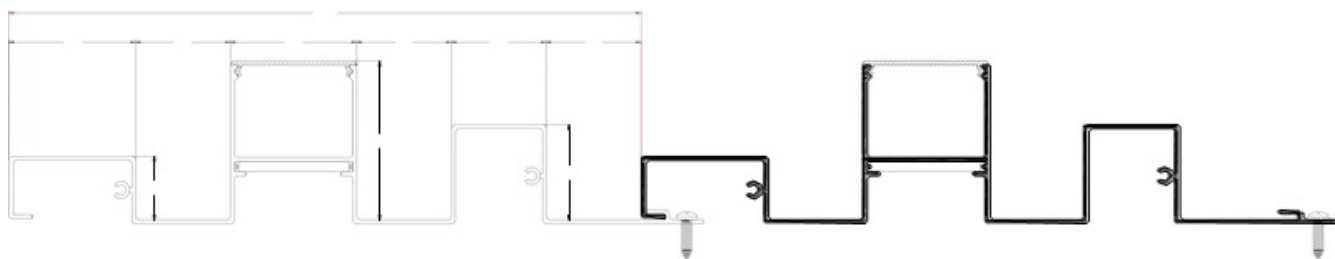

Epaisseur des profilés 1,2mm

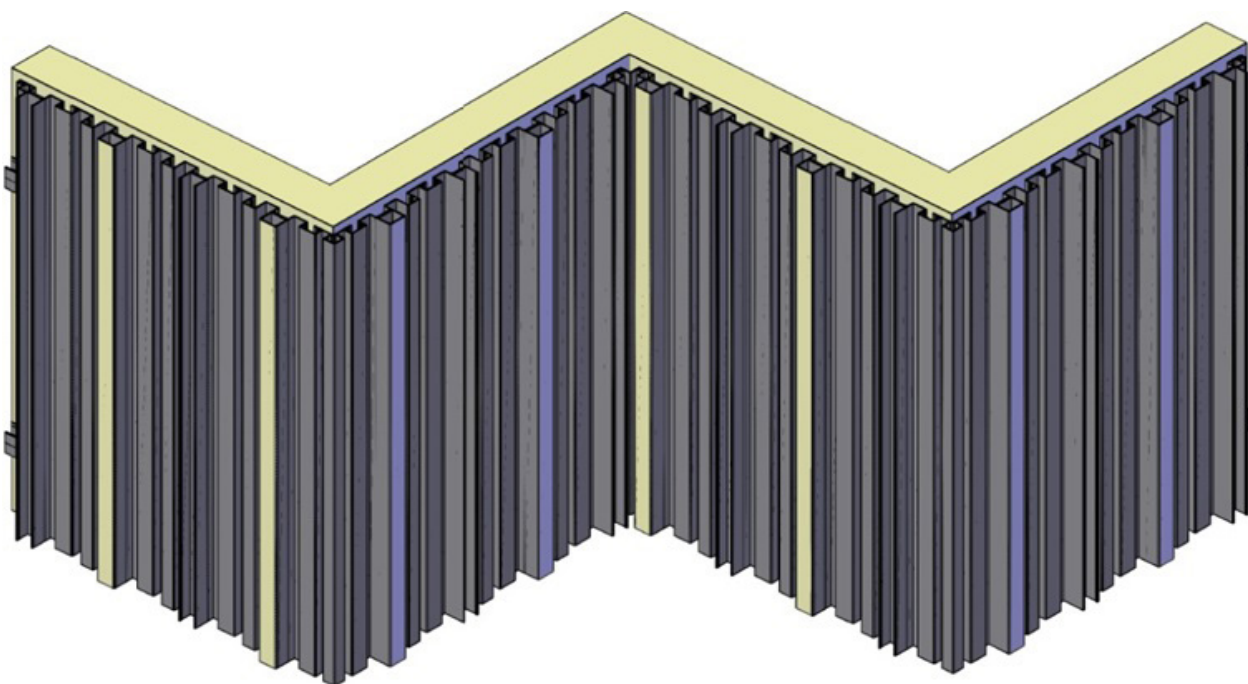
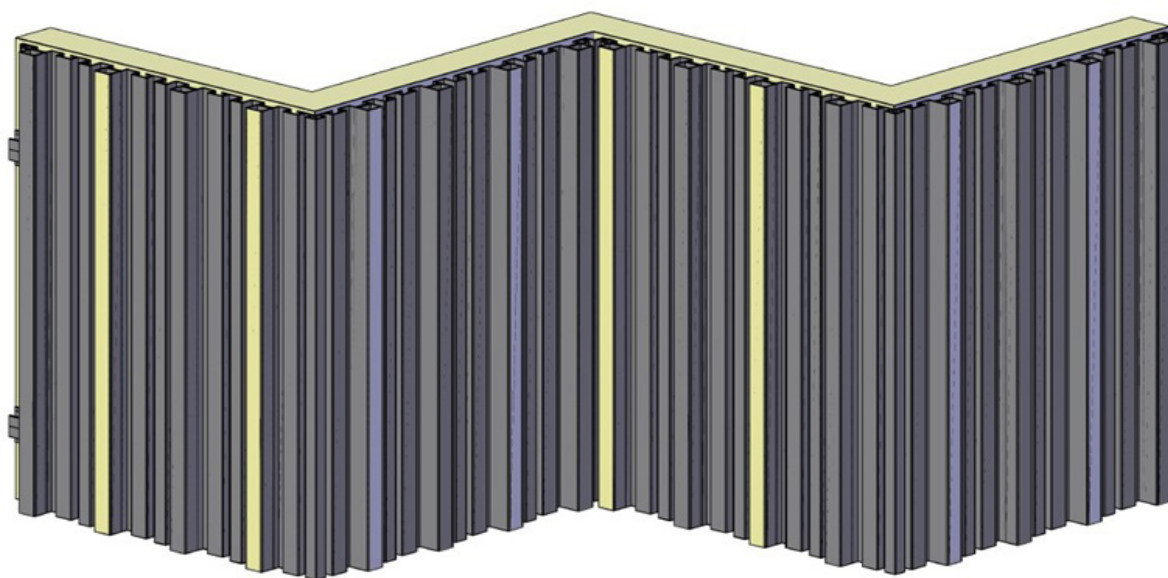



WD-2050 40x20 mm / 40x50 mm / 30x30mm

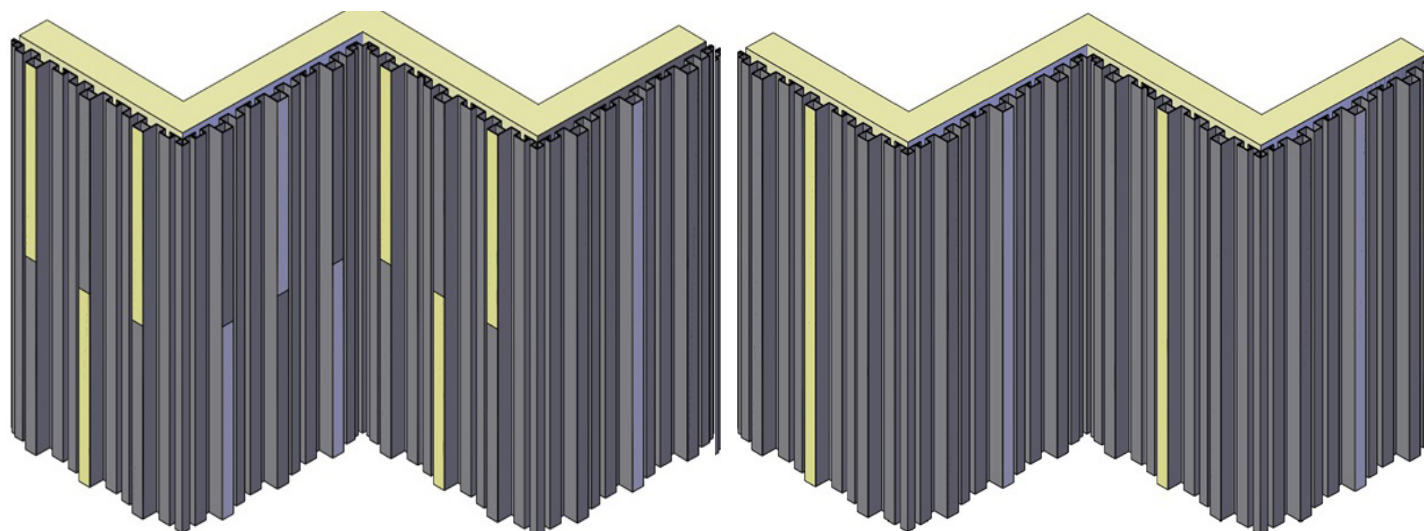
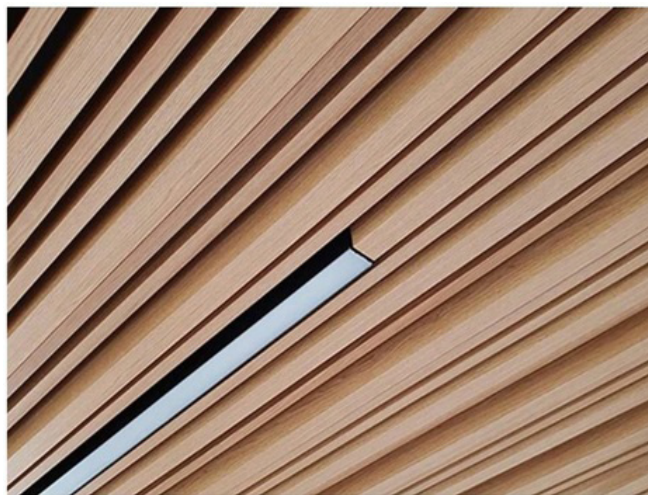

PF-070-015 / 195x21.2mm / décalage 20mm / 150mm de profilé visible

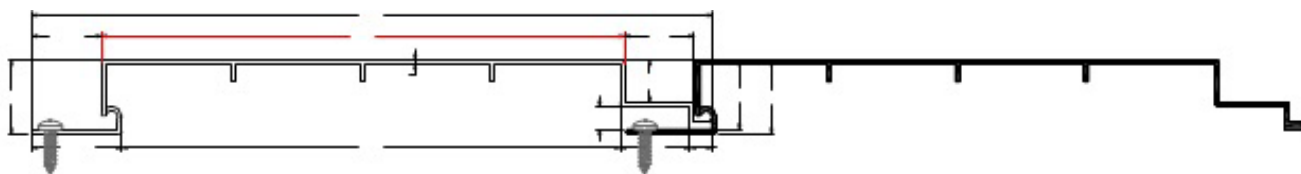

Epaisseur des profilés 1,2mm - 2,2mm

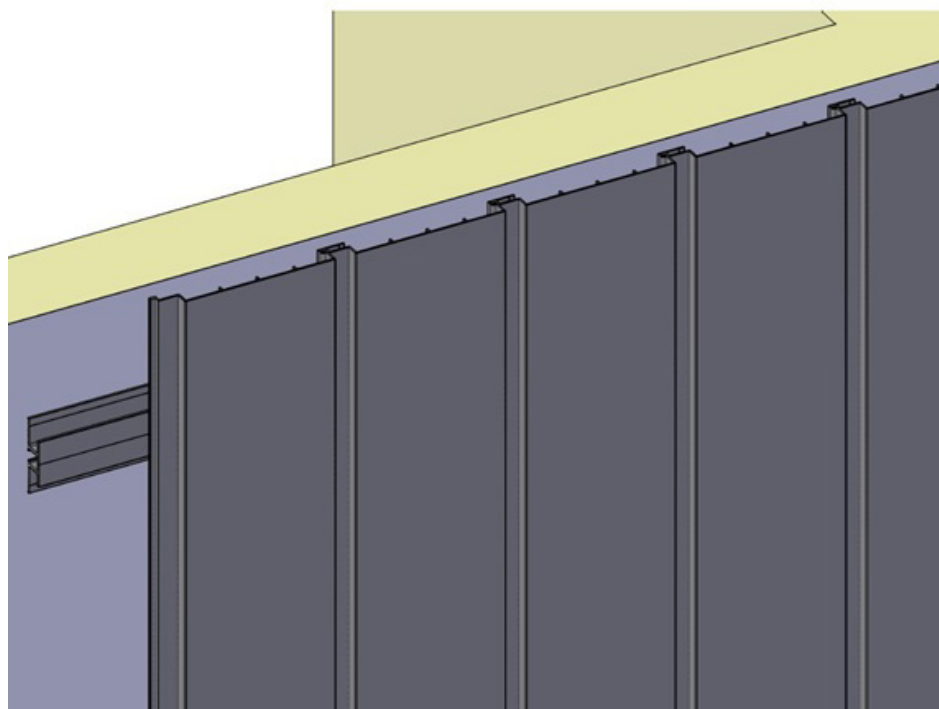

WD-2001 / 245x21.8mm / décalage 20mm / 200mm de profilé visible

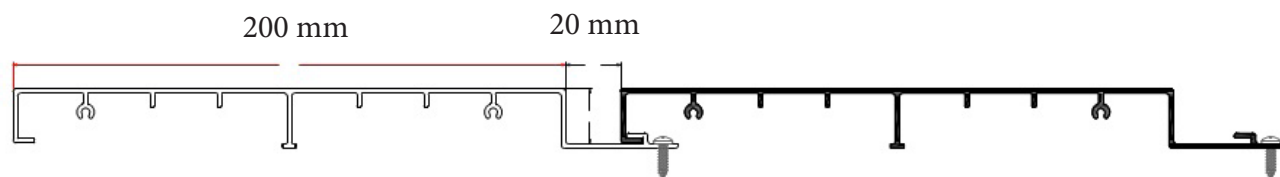

Epaisseur des profilés 1,6mm

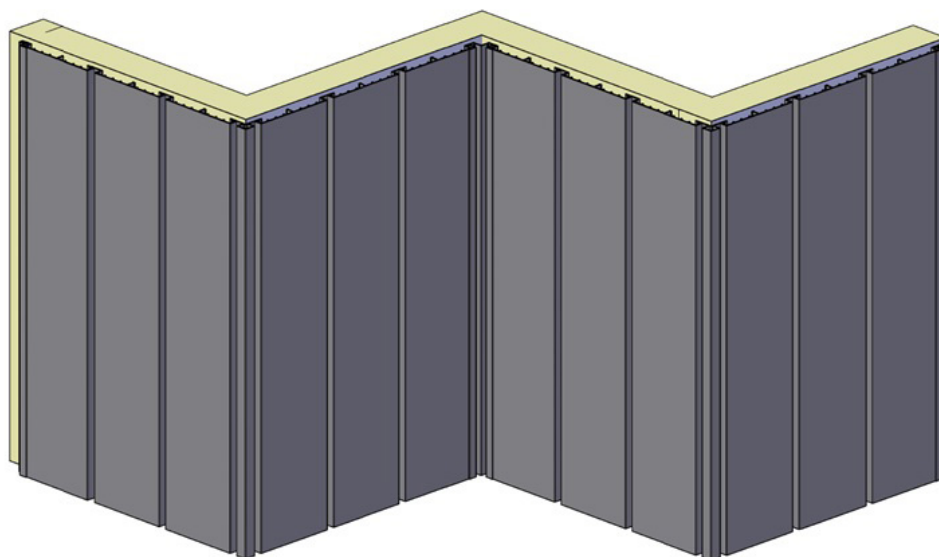

Combinaison de différents profilés

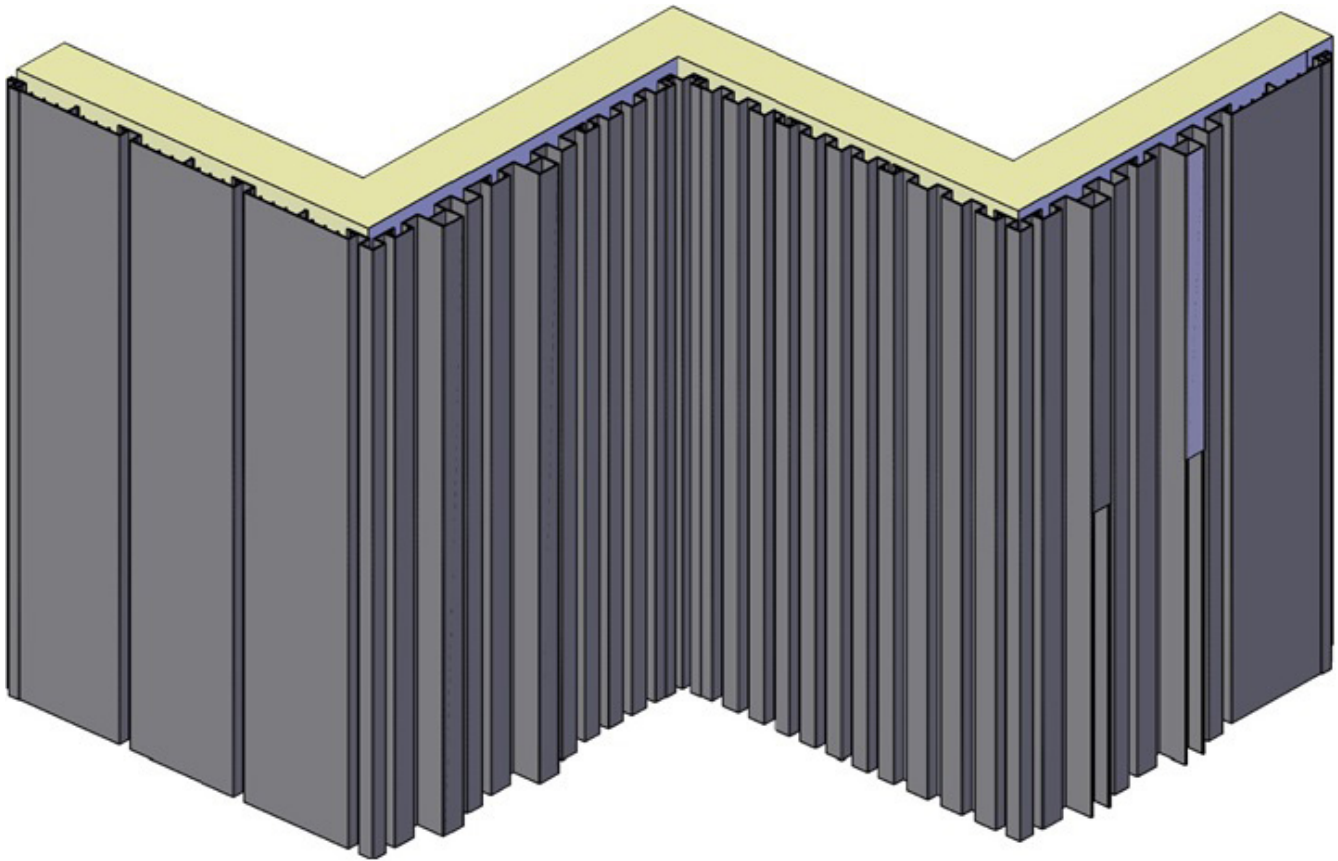

WD-3004 / 35.5x24mm

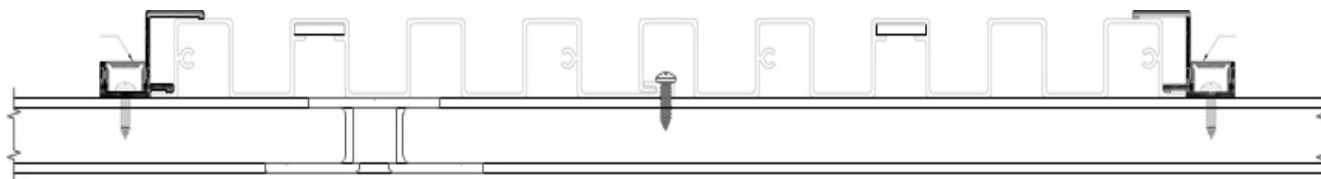

Epaisseur des profilés 1.5mm

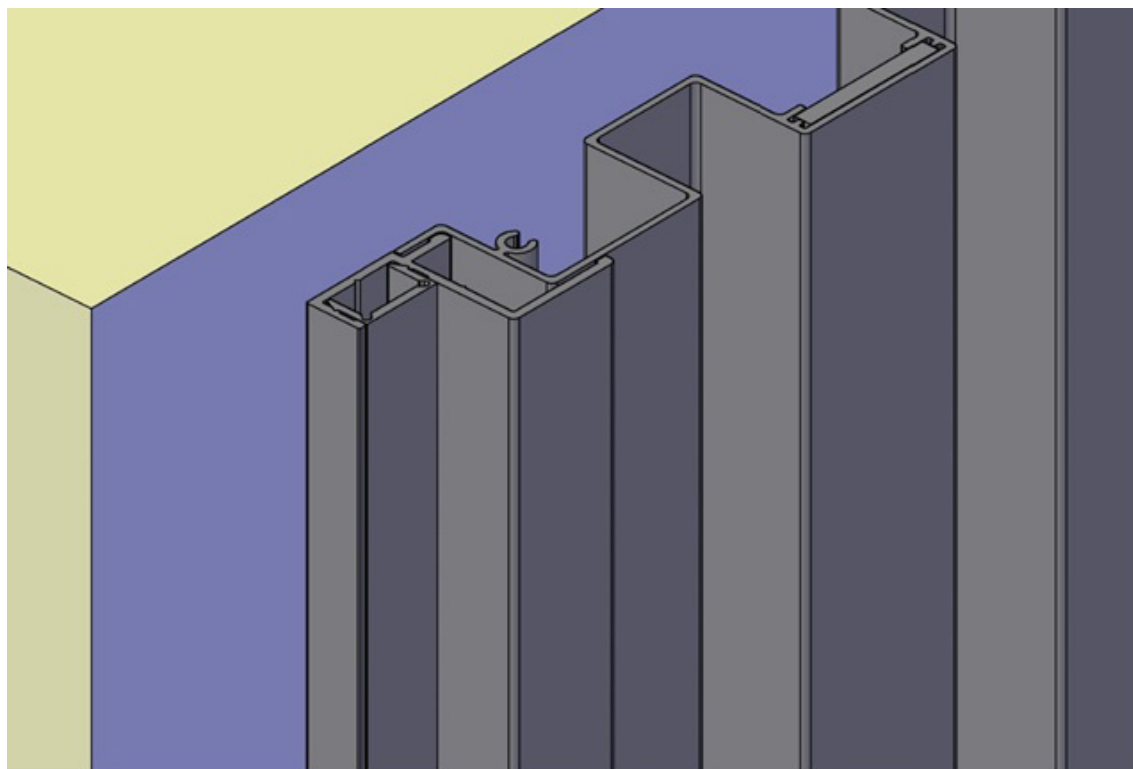
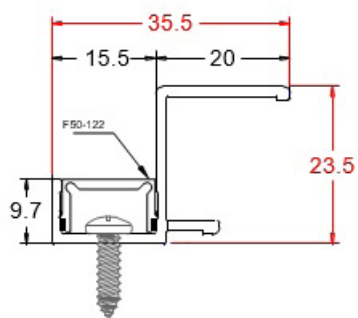

WD-1001 / 75x20mm

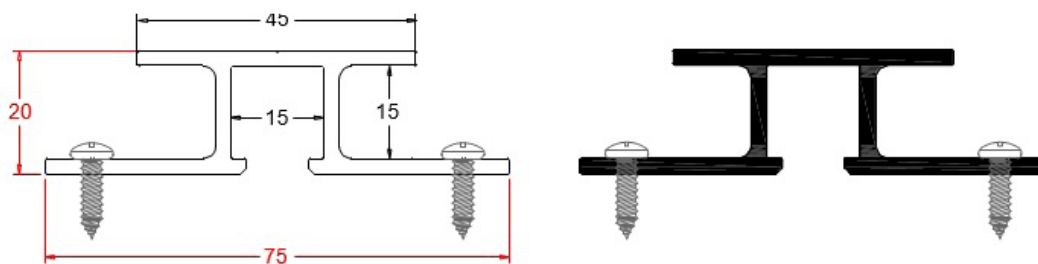

Epaisseur des profilés 2.5mm

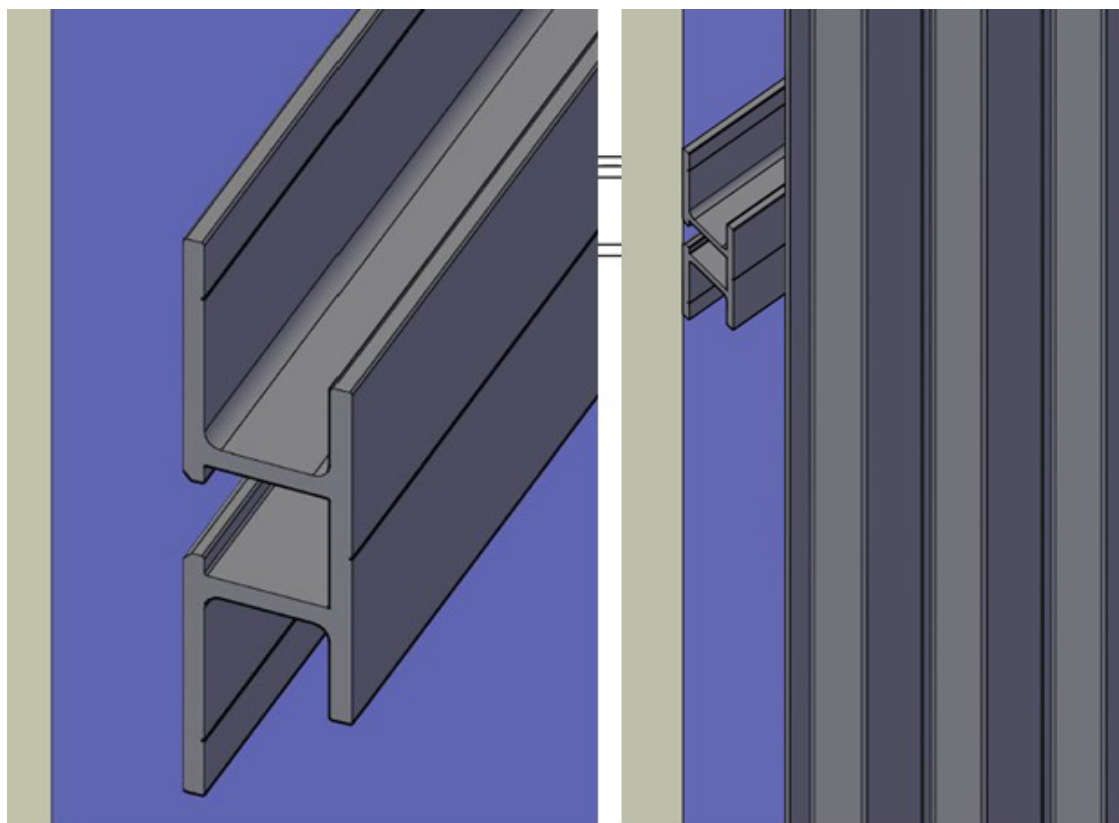
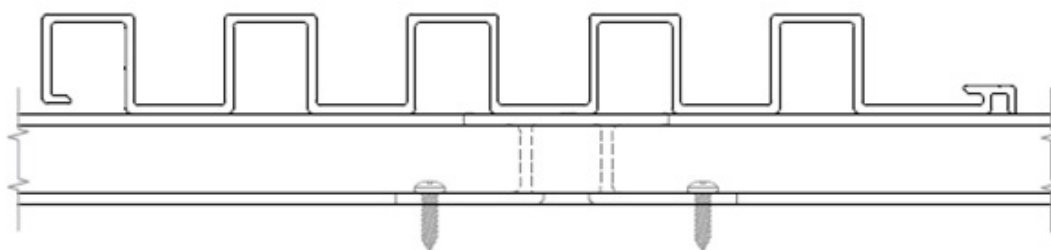

WD-5000 embouts aluminium / embouts plastic A240-002

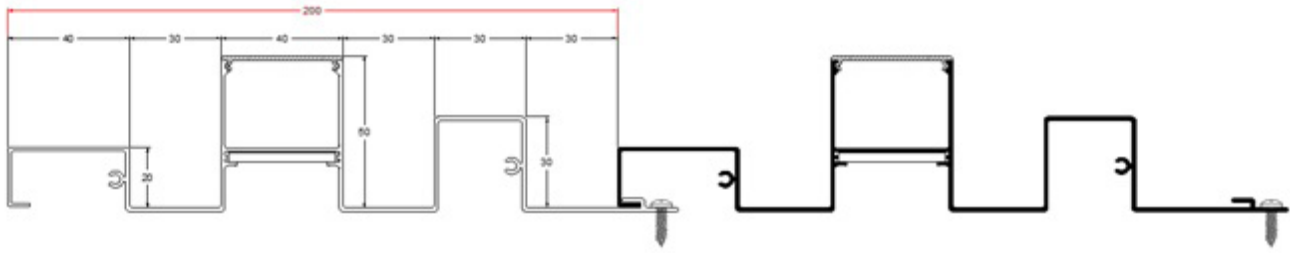

WD-5000 épaisseur 1.2 mm

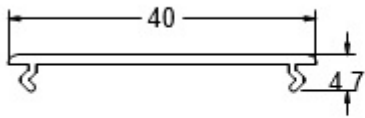

A240-002 épaisseur 1.2 mm

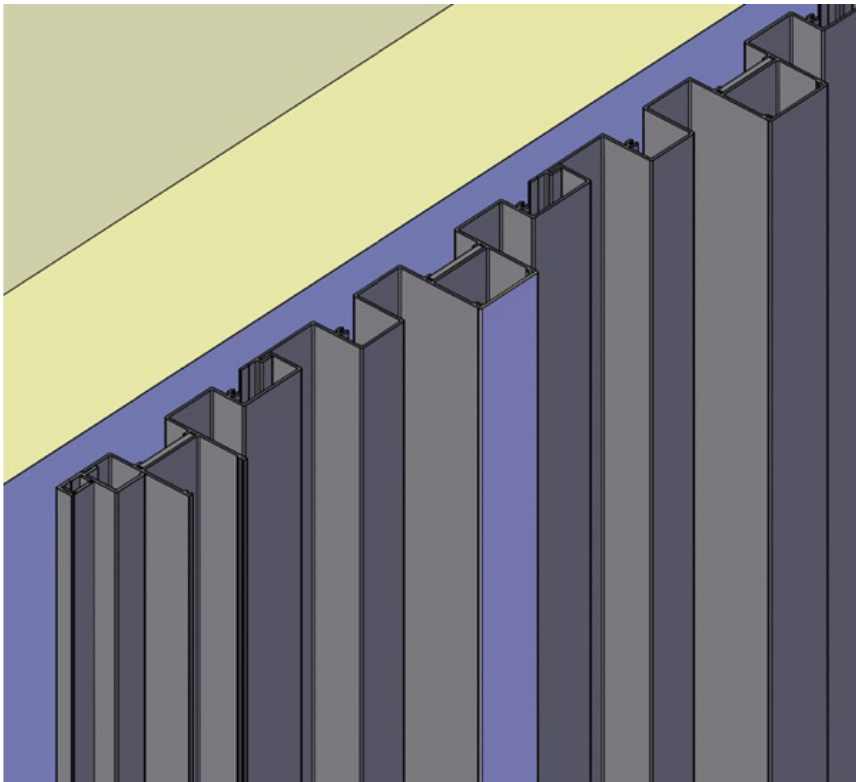
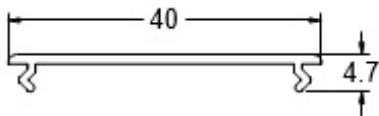

WD-3001 Profilé de coin extérieur

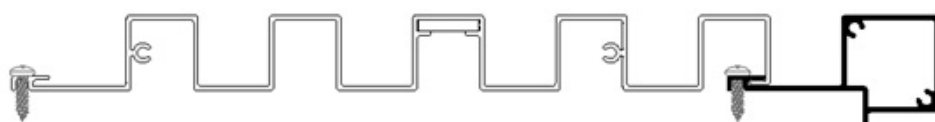

Profilé épaisseur 1.2 mm

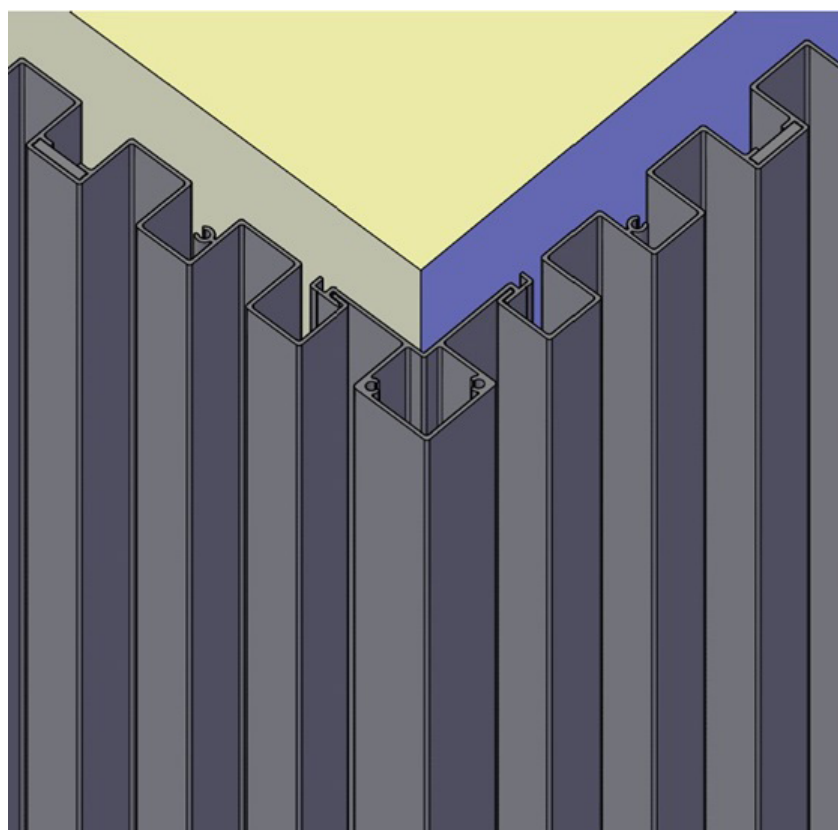
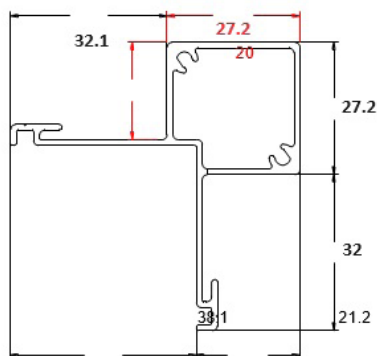

Coin extérieur / WD-3002

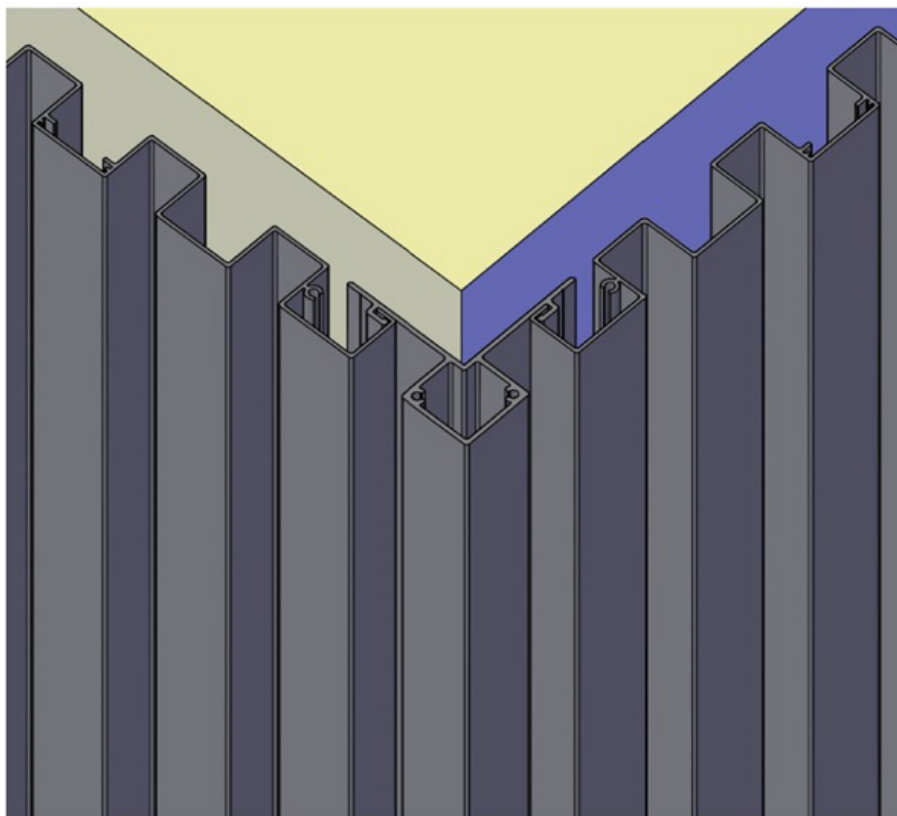
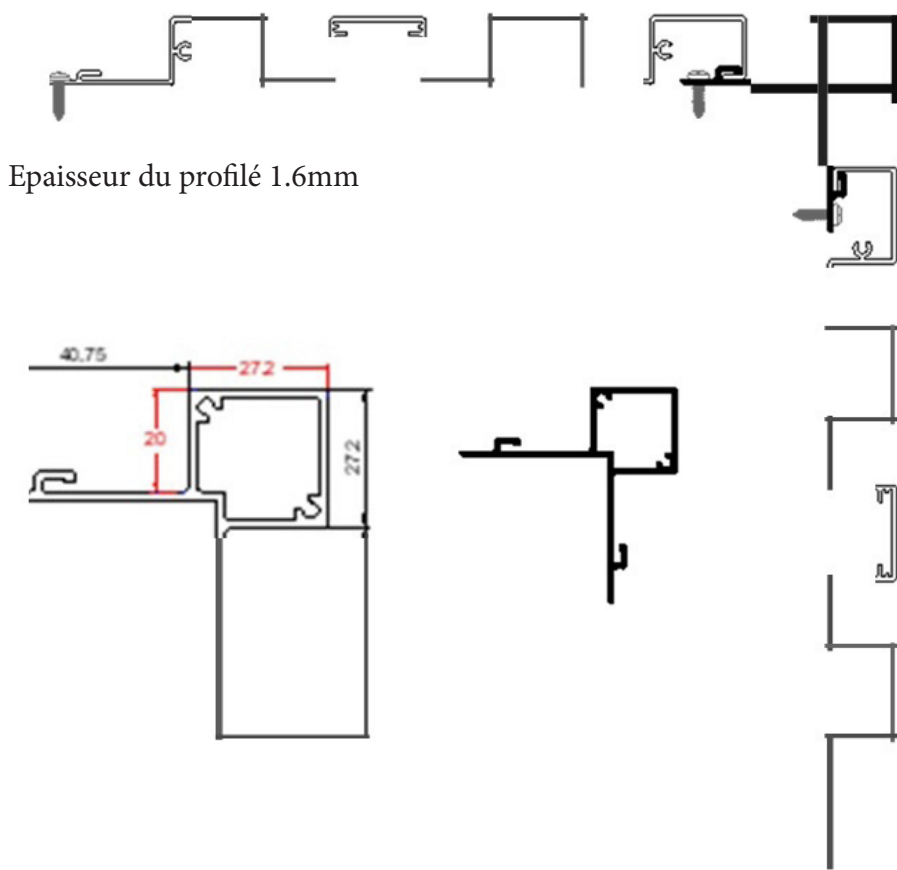

Coin intérieur/ WD-3003

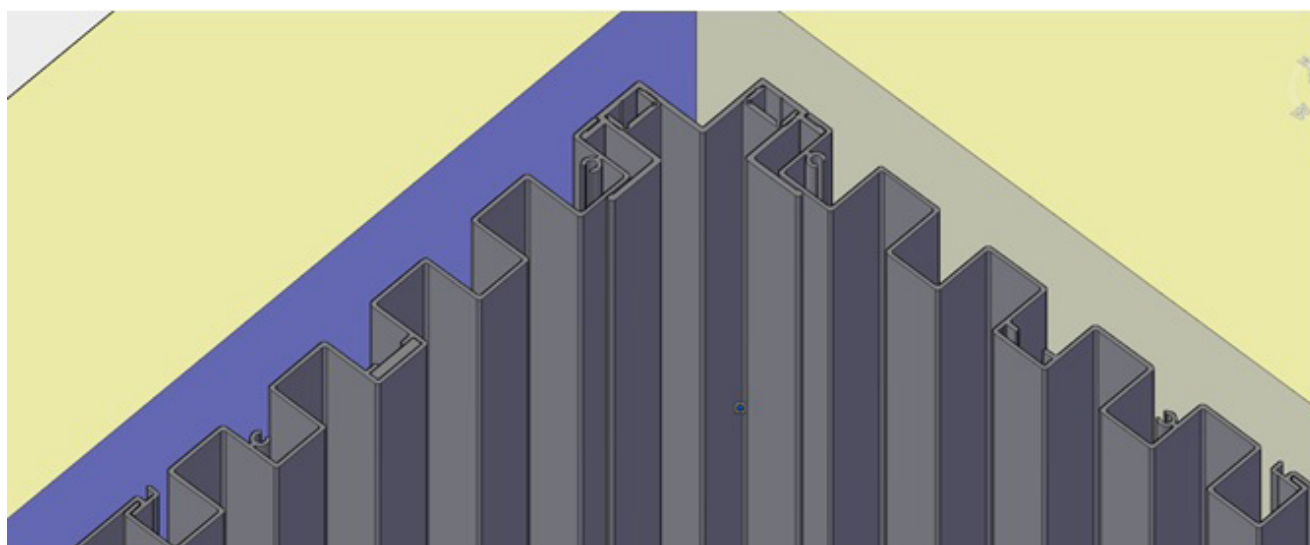
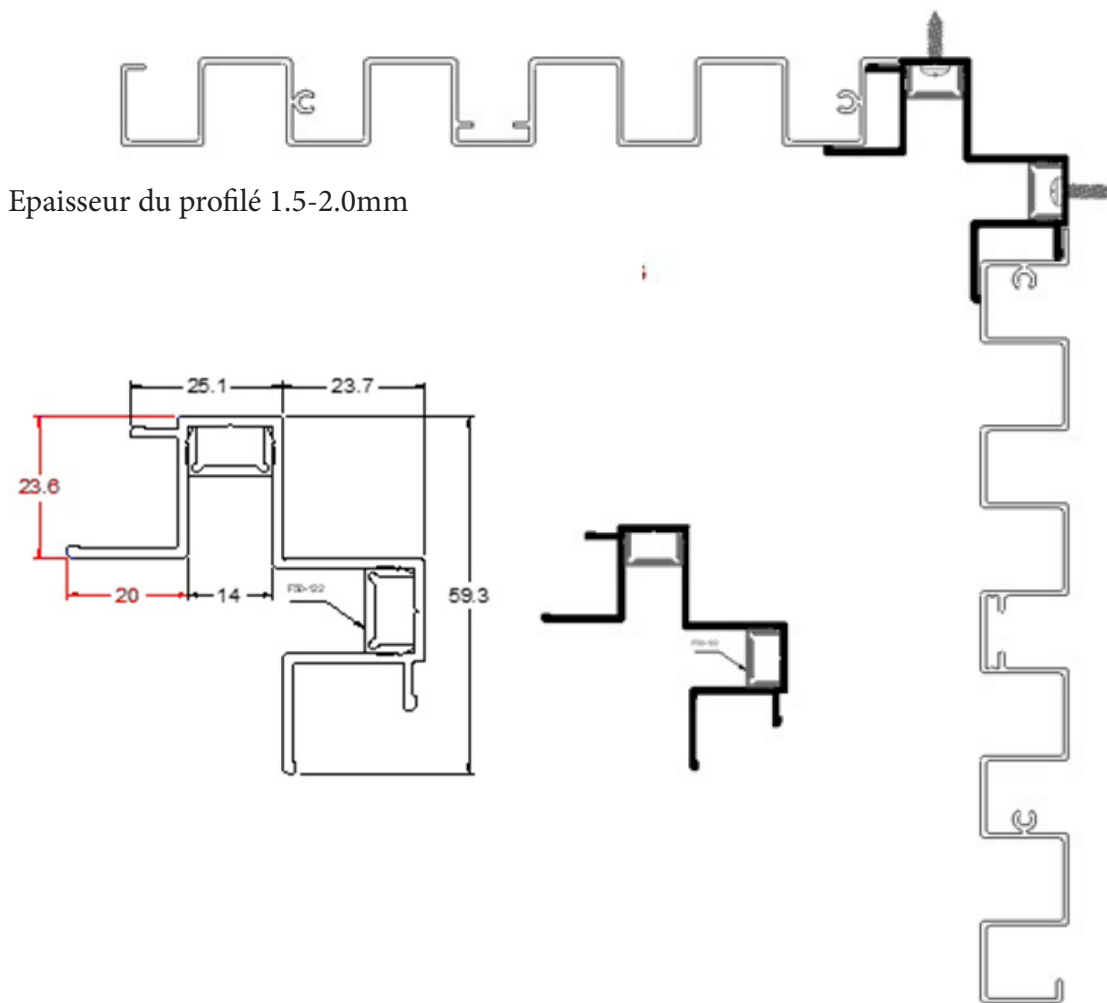

WD-4000 profilé additionnel pour LED

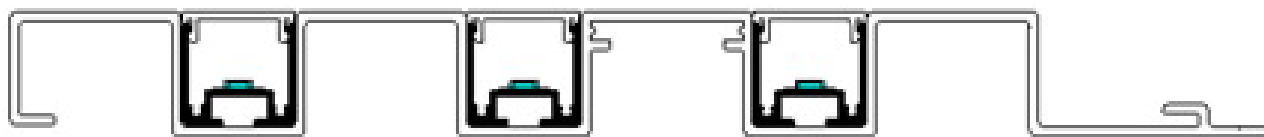

Epaisseur du profilé 1.0-1.6 mm

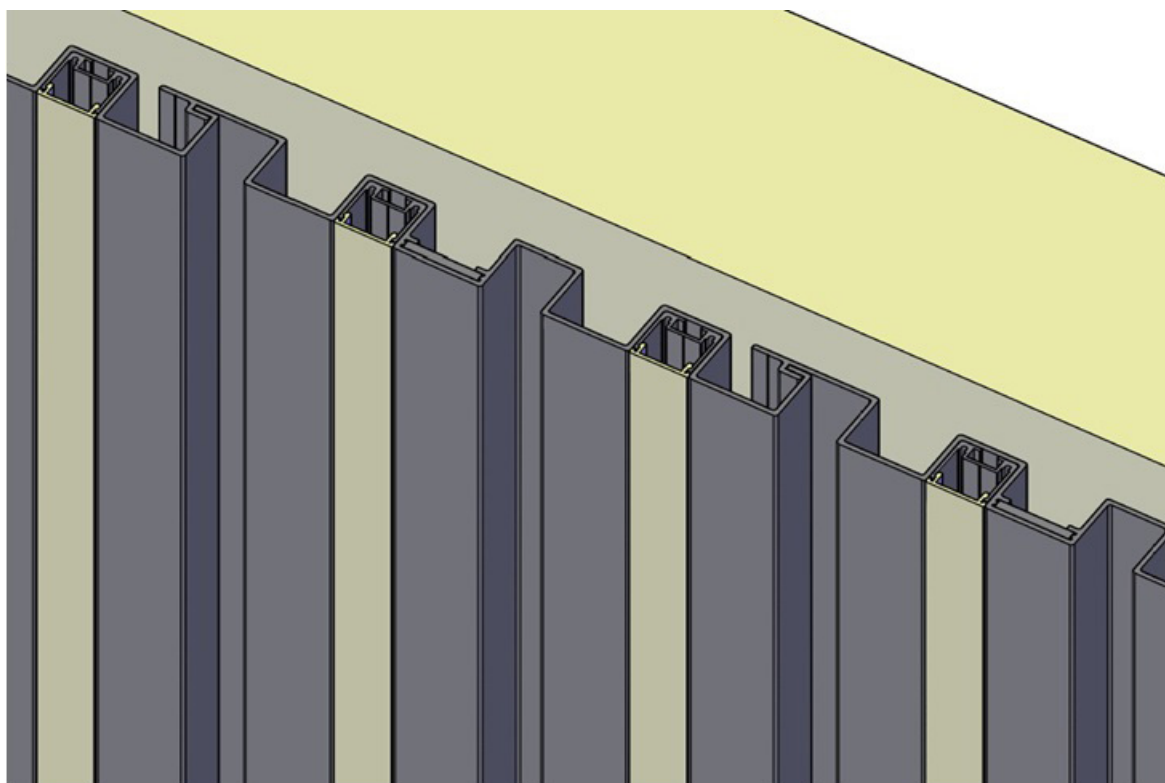
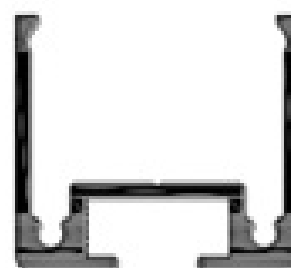
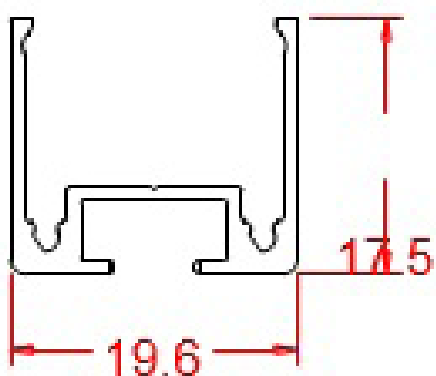

Option coin extérieur avec WD-3004

